

Lease Addendum 1/14/2022

Building: Ridge View Elementary School
3333 West Ridge Road
Hobart, IN 46342

- Starting January 1, 2022, Classrooms 19 & 20 are being added to the lease for Geminus Head Start.
- The monthly rent for the two additional classrooms 19 & 20 will be an additional \$486.00
- The new total monthly rent for Rooms 13 – 20 will be \$1,700.00

**LANDLORD:
ON SCHOOL CITY OF HOBART**

By: _____
Title: Terry Butler, School Board President

By: _____
Title: Sandra J Hillan, School Board Secretary

Date: _____

Date: _____

**TENANT:
GEMINUS CORPORATION**

By: _____

Title: _____

Date: _____

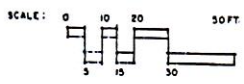
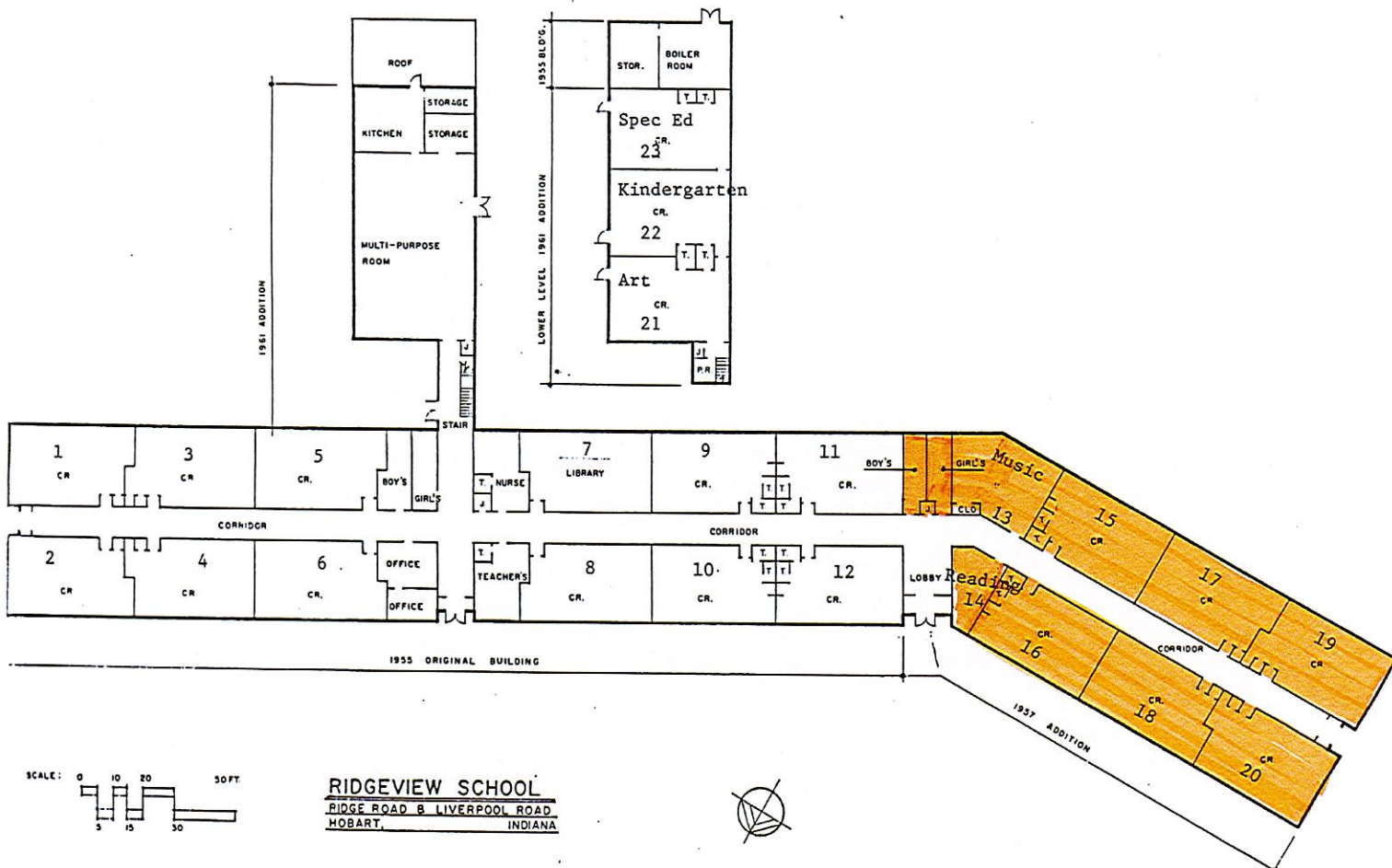

RIDGEVIEW SCHOOL
 RIDGE ROAD & LIVERPOOL ROAD
 HOBART, INDIANA



HOBART CITY SCHOOLS
 32 E. Seventh Street
 Hobart, Indiana 46342